

Brookside - 1 Bedroom

By Tiny Mountain Houses

Recreational Vehicle- DOT Compliant

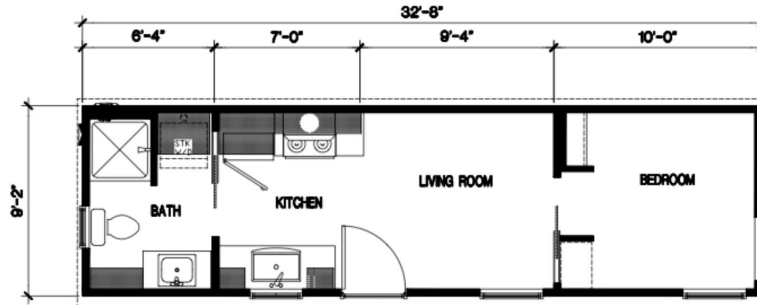

STANDARDS

- Deck over floorplan (No wheel wells)
- 4 integrated scissor jacks
- Windows residential Low E glazed, Argon gas
- Insulation Floor R19, Ceiling R28, Walls R-11
- Residential 50-year hardboard siding warranty
- Metal standing seam 40 year roof warranty
- Switched exterior holiday outlet
- Single slope shed style contemporary roof with eaves
- 36" Half lite entry door with a deadbolt
- 5/4 Rough-sawn trim throughout
- Porchlight, Electrical outlet/Patio plug
- Vinyl flooring throughout
- LED lighting
- Interior white textured sheetrock with volume ceilings
- 4" Baseboard with 2-1/2" Window & Door trim - painted white
- 32" Pocket door Bath & Bedroom
- Laminate counters and backsplash with bullnose edge
- Stainless top mount kitchen sink
- Faucet chrome
- Cabinetry Essentials white raised panel
- Brushed nickel cabinet and door hardware
- 30" propane range black
- 30" Black rangehood vented
- Prep area for 30"x 69" refrigerator
- Prepped for RV washer & 110v dryer
- On-demand 5.1 GPM tankless propane water heater
- Convection electric wall heat w/ thermostat
- Main Electric 50 Amp, 240 V
- Top mount china bath sink
- Residential elongated toilet
- 36" Shower, One-piece
- Framed Mirror over sink
- Towel and TP hardware satin nickel finish
- Brushed nickel cabinet and door hardware
- Prep for mini split

OPTIONS

- Upgrade exterior combo board n batten siding front door side & hitch end 50 year warranty
- LED TV in living room & bedroom w/swivel mount Incl high elect. outlet & cable ready
- LED can light packages living room & bedroom
- Black Micro/rangehood, Black Refrigerator 18 CF
- Level IV cabinets w/extended height overheads, soft close doors & drawers including 3" top trim
- Upgrade cabinet hardware
- Pullout trash drawer
- Double sconce lights over bath sink, Matte Black
- Medicine cabinet bathroom
- LED light over the shower
- T & G pine ceiling in LRM & Kitchen w/ poly clear coat, matte finish
- Added fans ceiling fan LRM & bedroom
- 1" mini blinds t/ out
- Upgrade tile kitchen & bath
- Linen cabinet in bath above W/D area
- Single zone mini split heating and cooling system
- 10' bedroom w/ closets
- Extended LRM 8"
- Transom window over the entry
- Bedroom closet & extended height custom cabinets w. dresser drawers & custom butcher block insert in cubby
- Custom chunky edge butcher block table/ desk

Want to get pricing on your own Brookside?
Scan the QR Code!



Base Price
\$49,995

Options Total
\$32,730

As Shown
\$82,725

*Price does not include doc fees, freight & applicable taxes. Furnishings and decor not included

VIN31009
9' 2" wide x 32'8" long
x 14'0" tall
Approximately 303 sq. ft.
12,900 lb. dry weight